

# TIGA

## FACADE CONNECTOR

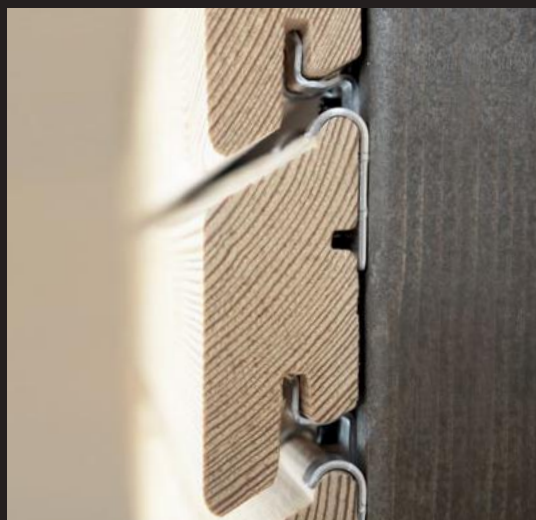

The **TIGA** Facade Connector ensures simple, fast, and secure installation of open cladding profiles made of wood or wood-like materials.

This concealed clip-in connection protects the facade surface from the effects of the weather and provides perfect structural protection.

The installation and positioning guide makes it easy to position the cladding profile and automatically sets the distance between the joints.

The fixing system features a sliding and fixed-point installation, providing optimum controlled compensation for natural swelling and shrinking.

### OVERVIEW

<b>Material:</b>	TIGA: Aluminium-zinc coated sheet metal
	TIGA2: Stainless steel A2 1.4301
	System screw UNIA: Hardened stainless steel
<b>Fire rating:</b>	Assured by metal connectors
<b>Fastening type:</b>	Concealed sliding and fixed point fixing
<b>Facade profile:</b>	Specific TIGA profile

TIGA		
Description	PU	Prod. No.
Alu Zinc	<b>100 PCS</b>	005804002
Alu Zinc	<b>800 PCS</b>	005812000
Starter Piece	<b>50 PCS</b>	006202002

TIGA2		
Description	PU	Prod. No.
Stainless steel	<b>100 PCS</b>	006004000
Stainless steel	<b>800 PCS</b>	006012000
Starter Piece	<b>50 PCS</b>	006302000



### SET-PACK

Each package contains the UNIA1 4.2 x 28 mm system screws required for installation and assembly instructions

**BRANDING**  
Custom branding upon request



Easy positioning of the cladding profile with integrated mounting and positioning guide

A single screw saves assembly time and ensures a secure fixation

Starter clip for the installation of the first row

Click-in mechanism for intuitive, screwless profile attachment

Mounting hooks hold the profile perfectly in place without damaging the profile

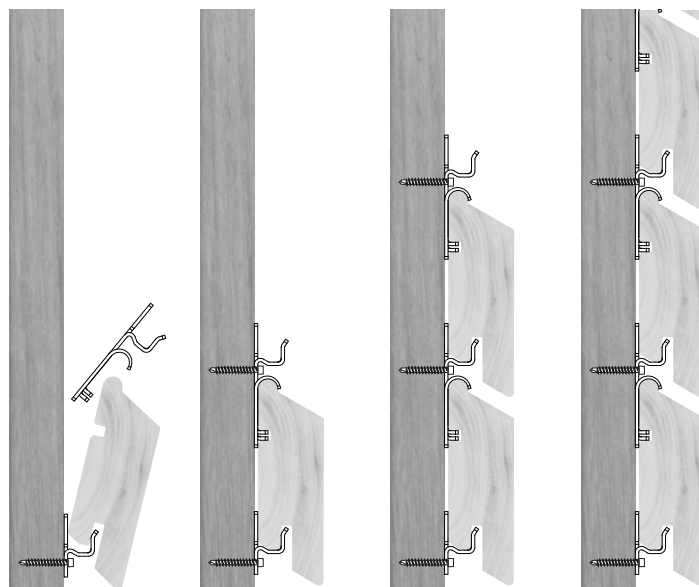
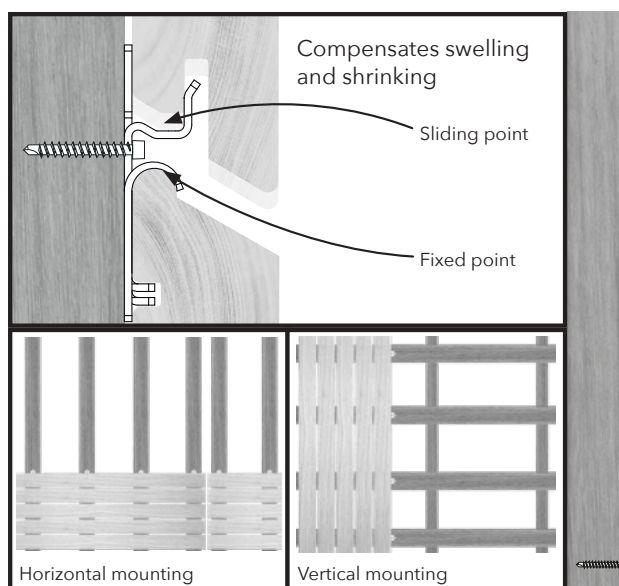

**TIGA-Profile**

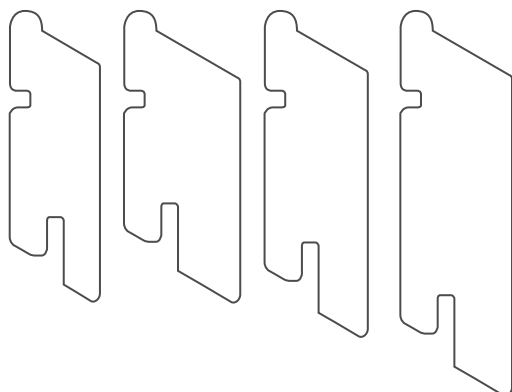

Maximum flexibility in the design selection.

TIGA cladding profiles can be produced in a wide range of dimensions, wood species and surface finishes.

Local building regulations must be followed.

#### DOWNLOADS



Installation



Board exchange



Data sheet



Tips & Tricks



Video